

# **FINN** **CORPORATION®**

9281 LeSaint Drive • Fairfield, Ohio 45014  
Phone (513) 874-2818 • Fax (513) 874-2914  
Toll Free (800) 543-7166

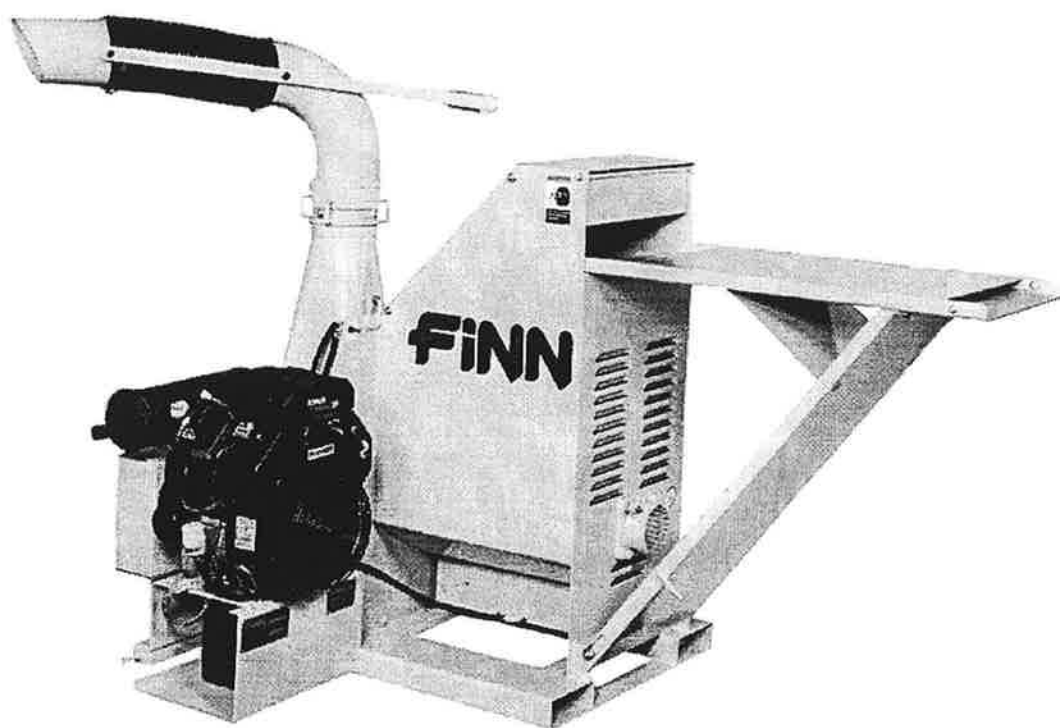

## **B-40**

### **Mulch Spreader**

#### **Parts and Operator's Manual**

Model **SSA**

Serial No. \_\_\_\_\_

## WARRANTY

Finn warrants to the original Purchaser for use (or rental to others for use) all new construction machinery and attachments therefore manufactured by Finn to be free from defects in material and workmanship for a period of 12 months from date of purchase or 1200 hours of use, whichever comes first. Replacement parts provided under the terms of this warranty are warranted for the remainder of the warranty period applicable to the product in which installed, as if such parts were original components of that product. Finn makes no warranty with respect to (a) allied equipment or trade accessories not manufactured by it (such as, but not limited to tires, ignitions, starters, hose, batteries, magnetos, carburetors, engines or like or unlike equipment or accessories), such being subject to the warranty, if any, provided by their respective manufactures; or (b) secondhand, used, altered, or rebuilt machines. Further, the warranty herein expressed shall be rendered null and void to the extent any defect or failure of the products warranted hereby arises out of or is caused by accessories or component parts not manufactured or supplied by Finn, whether same are supplied by Purchaser, dealers or any other party. THE WARRANTY DESCRIBED IN THIS PARAGRAPH SHALL BE IN LIEU OF ALL OTHER WARRANTIES, EXPRESS OR IMPLIED, INCLUDING, BUT NOT LIMITED TO, ANY IMPLIED WARRANTY OF MERCHANTABILITY OR FITNESS FOR A PARTICULAR PURPOSE.

Upon notification of Finn during the above-stated warranty period of any failure to conform to this warranty, and upon inspection by Finn to verify said nonconformity and verify the continuing existence of the warranty period, Finn will provide a new part or a repaired part, whichever Finn elects, to replace the part found to be defective. Such parts will be provided without charge to the Purchaser during normal working hours at a place of business of a Finn dealer or other establishment authorized by Finn to effect said repairs or replacements, but Purchaser shall bear all costs of transporting the product to and from such place of business or establishment. Correction of nonconformities, in the manner and for the period time provided above, shall constitute fulfillment of all liabilities of Finn under this contract.

THE REMEDIES OF THE USER SET FORTH HEREIN ARE EXCLUSIVE, WITHOUT REGARD TO WHETHER ANY DEFECT WAS DISCOVERABLE OR LATENT AT THE TIME OF DELIVERY OF THE PRODUCT TO THE PURCHASER.

The essential purpose of this exclusive remedy shall be to provide the Purchaser with repair or replacement of parts that prove to be defective within the period and under the conditions previously set forth. This exclusive remedy shall not have failed of its essential purpose (as that term is used in the Uniform Commercial Code) provided Finn remains willing to repair or replace defective parts within a commercially reasonable time after it obtains actual knowledge of the existence of a particular defect.

IN NO EVENT SHALL FINN BE LIABLE FOR ANY SPECIAL, CONSEQUENTIAL, INCIDENTAL OR INDIRECT DAMAGES, INCLUDING LOST PROFITS OR LOST COMMERCIAL OPPORTUNITIES, WITH RESPECT TO THE SALE OF THE ABOVE WARRANTED PRODUCT OR ANYTHING DONE IN CONNECTION THEREWITH, OR FOR PROPERTY DAMAGE SUSTAINED BY A PERSON CLAIMING TO BE A THIRD PART BENEFICIARY OF A SURVIVING WARRANTY UNDER THE LAW OF ANY JURISDICTION.

## NOTICE

FINN CORPORATION URGES THE USE OF ONLY FINN CORPORATION SUPPLIED PARTS AND ATTACHMENTS TO ASSURE PROPER PERFORMANCE AND SAFE OPERATION OF FINN CORPORATION EQUIPMENT. INSIST ON PARTS AND ATTACHMENTS MANUFACTURED OR SUPPLIED BY FINN CORPORATION WHEN YOU PURCHASE, REPAIR OR REPLACE YOUR FINN EQUIPMENT AND ATTACHMENTS.

BECAUSE FINN CORPORATION CANNOT ASSURE THAT PARTS AND ATTACHMENTS NOT MANUFACTURED OR SUPPLIED BY FINN MEET FINN CORPORATION'S QUALITY STANDARDS, SPECIFICATIONS, OR OPERATING REQUIREMENTS, OUR WARRANTY IS NOT EFFECTIVE TO THE EXTENT ANY FAILURE OF OR DEFECT IN A FINN CORPORATION PRODUCT ARISES FROM OR IS CAUSED BY PARTS, ATTACHMENTS OR COMPONENTS NOT ORIGINATING WITH FINN CORPORATION. USE OF FINN CORPORATION EQUIPMENT WITH PARTS AND ATTACHMENTS NOT MANUFACTURED OR SUPPLIED BY FINN COULD RESULT IN PERSONAL INJURY.

Effective December 8, 1995

### Proposition 65 Warning

The engine exhaust and some of its constituents are known to the State of California to cause cancer, birth defects, and other reproductive harm.

### Proposition 65 Warning

Battery posts, terminals and related accessories contain lead and lead compounds, chemicals known to the State of California to cause cancer and reproductive harm. Wash hands after handling.

# INDEX

---

Safety First.....	1
Safety Summary Section .....	2-5
Definition of Mulching .....	6
Towing Vehicle .....	6
Loading Bales .....	7
Pre-Start Check .....	7
Equipment Check .....	7
Starting Procedure .....	8
Crew Members and Their Duties .....	8
Blower Discharge.....	9
Cleaning and Maintenance .....	10
Lubrication Chart .....	11
Parts Manual Section.....	13-21
Parts Manual Index .....	15
Warranty Registration Card .....	23



# **SAFETY FIRST**

With any piece of equipment, new or used, the most important part of its operation is SAFETY!

Finn Corporation encourages you and your employees to familiarize yourselves with your new equipment and to stress safe operation.

The first six pages of this manual are a summary of all the main safety aspects associated with this unit. Be sure to read completely before operation of machine.



This symbol is used throughout the operation and maintenance sections of this manual to call attention to safety procedures.  
- Pay Attention -



## **DANGER:**

Immediate hazards which WILL result in severe personal injury or death.



## **WARNING:**

Hazards or unsafe practices which COULD result in severe personal injury or death.



## **CAUTION:**

Hazards or unsafe practices which COULD result in minor personal injury or product or property damage.

## **IMPORTANT:**

Indicates that equipment or property damage could result if instructions are not followed.

## **NOTE:**

Gives helpful information.

Finn Corporation

### **Proposition 65 Warning**

The engine exhaust and some of its constituents are known to the State of California to cause cancer, birth defects, and other reproductive harm.

### **Proposition 65 Warning**

Battery posts, terminals and related accessories contain lead and lead compounds, chemicals known to the State of California to cause cancer and reproductive harm. Wash hands after handling.

# MULCH SPREADER SAFETY SUMMARY SECTION

It is important that all operators of this machine are familiar with all of the safety aspects mentioned below and have read the entire Operator's Manual before operating the machine. Always keep a copy of this manual with the machine. It is the responsibility of the operator of the machine to fully understand this safety sheet. Remember that YOU are the key to safety. Good safety practices protect not only you but also the people working with and around you. Keep in mind that this safety sheet is written for this type of machine only. Practice all other usual and customary safe working precautions; and above all, remember that safety is up to you.

The FINN MULCH SPREADER is intended to be used as an applicator of vegetative hay or straw mulches onto the seedbed. Its use with other products or for other applications must be by approval of the product's manufacturer. If there are any questions contact FINN Corporation at 1-800-543-7166.

## I. PRE-START EQUIPMENT CHECK (equipment check is to be made with the engine off):

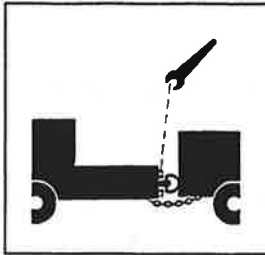
1. Check hitch and hitch bolts, safety chains, lights, brakes and breakaway switch (if this option is provided). Verify that the hitch ball is the correct size for the coupler.
2. Check that all guard railing is in place and secure.
3. Verify that all guards are in place.
4. By carefully looking in the shredder box, inspect the shredder box for foreign objects.
5. Make sure no one is working on or inside the machine. Signal "All Clear" before starting the engine.

## II. MACHINE OPERATION:

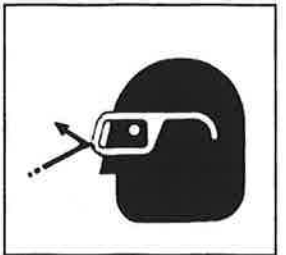
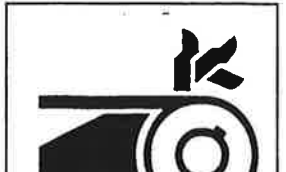
1. Always wear safety goggles when operating or feeding the machine. Other safety attire such as safety shoes, ear protection, gloves, hard hats, dust masks, etc., should be worn as required by warning decals on machine, operator's manuals, or jobsite requirements. Remove rings, watches, etc. Avoid loose fitting clothing that may get caught in rotating machinery.
2. Do not operate the machine without all guards in place.

3. Make sure the discharge spray area is clear of all persons, animals, etc.
4. The driver of the carrying or towing vehicle is responsible for the safety of the operator(s) and feeder(s) of the machine. Make sure the driver is aware of and avoids all possible hazards to the operator(s) on the machine, such as tree limbs, low power lines, etc. Vehicles on which equipment is mounted or towed must be started or stopped gradually. Avoid abrupt starts and stops. Never operate on a slope or a hill that may endanger the operator(s). All personnel should review and be familiar with start/stop signals between the driver and operator(s) before operation of the equipment.
8. Never modify the machine. Never remove any part of the machine (except for service and then reinstall before operating).
9. Use proper means for mounting and dismounting of machine. Never mount or dismount a moving machine.
10. Do not aim discharge at people, animals, etc. Only aim the discharge at the intended seedbed.
11. Do not open any doors or access panels while machine is in operation. Severe injury may result from rotating parts.



5. Operator(s) of equipment should never ride on machine at speeds greater than 5 MPH (8km/h).



6. Never operate machine in an enclosed area without venting the exhaust of both the equipment and the vehicle on which the equipment is mounted or towed. Deadly carbon monoxide fumes can accumulate.

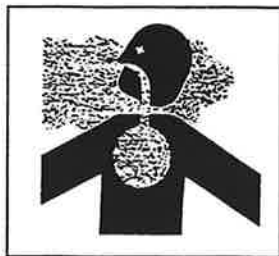

7. Never operate this or any other machinery when fatigued, tired, under the influence of alcohol, illegal drugs or medication. You must be in good physical condition and mentally alert to operate this machine.

12. Do not attempt to pull anything out of the feed chute or shredder box when machine is in operation. **DO NOT REACH INTO THE BEATER BOX** while the machine is running. Shut down the engine, using OSHA lockout/tagout procedure (29CFR 1910.147) before removing any foreign objects. Signal "All Clear" before restarting the machine.

### III. MAINTENANCE:

1. Before servicing the machine, turn off engine and allow all moving parts to stop. Disconnect the battery cables to prevent accidental starting of the machine. Tag the engine operating area to show that the machine is being serviced. Use lockout/tagout procedure (29 CFR 1910.147).



2. On trailer units perform general maintenance such as checking the safety chains, hitch and hitch bolts, tires, and brakes. Repair or replace if worn or broken. Never operate machine on improperly inflated or damaged tires. Always use a safety cage or cable restraints when reinflating a repaired tire.

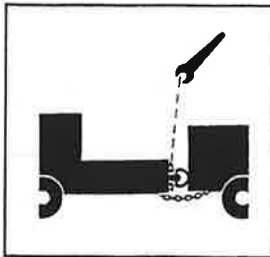

3. Battery maintenance. Lead-acid batteries contain sulfuric acid which damage eyes or skin on contact. Always wear a face shield to avoid acid in the eyes. If acid contacts eyes, flush immediately with clean water and get medical attention. Wear rubber gloves and protective clothing to keep acid off skin. Lead-acid batteries produce flammable and explosive gases. Keep arcs, sparks, flames, and lighted tobacco away.
4. Filling of fuel. Never fill the fuel tank with the engine running, while smoking or when near an open flame. Never smoke while handling fuel or working on the fuel system. The fumes in an empty container are explosive. Never cut or weld on fuel lines, tanks, or containers. Move at least 10 feet (3 meters) away from fueling point before starting engine. Wipe off any spilled fuel and let dry before starting engine.

NOTE: Be careful not to allow fuel, lubricant, hydraulic fluid, or cooling fluids to penetrate into the ground or be discharged into the water system. Collect all used fluids and dispose of them properly.

5. It is recommended that only authorized genuine FINN replacement parts be used on the machine.

6. Make certain that all decals on the machine are maintained in good legible condition. Replacement decals are available through FINN Corporation by specifying the part number shown in the lower right hand corner of the decal. See page 5 for the current set of safety decals mounted on the unit. See Parts Manual for the location and quantity of all decals on this unit.



## CURRENT SET OF SAFETY DECALS

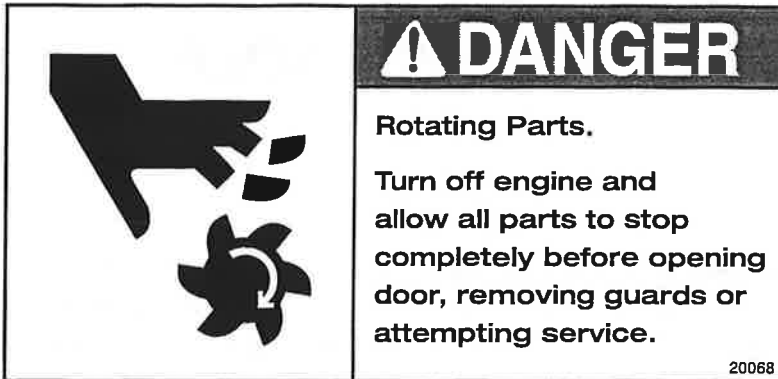

# **OPERATION AND MAINTENANCE MANUAL FOR THE B-40 MULCH SPREADER**

This manual is designed for step by step instructions of the operation, care, and maintenance of the B-40 Mulch Spreader and, in addition, it contains illustration and descriptions of a complete list of parts and components for easy identification. For best results and to insure longer life of the equipment, please follow the instructions carefully. For your safety read the entire manual before operation of this unit.

## **DEFINITION OF MULCHING:**

Mulching is the process whereby a vegetative mulch such as hay or straw, sometimes excelsior or other wood product or other vegetative material is spread on previously seeded areas to promote germination, while providing temporary erosion control.

## **THE FINN B-40 MULCH SPREADER AND HOW IT WORKS:**

The Finn B-40 Mulch Spreader will apply vegetative mulch at a fast and uniform rate utilizing a minimum amount of manpower.

The baled vegetative mulch material is placed on the feed chute and separated by the bale feeder as he feeds these bales into the beater box. In the beater box a combination of beater assemblies and air currents separates the mulch into individual fibers, which are drawn into the blower housing and blown through the discharge assembly onto the seedbed.

## **TOWING VEHICLE:**

The truck used to tow the Finn B-40 Mulch Spreader should have a bed large enough to carry the quantity of mulch needed for economical operation. The truck must be equipped with a 2" ball hitch rated at 3000 lbs. (1358 kg). The tow vehicle must be able to support a minimum of 400 lbs. (181 kg) down on its hitch.

## LOADING BALES:

Load the bales of mulch on the truck bed with binder twine or wire on top rather than on the side. This makes it easier to grab the bales while the Mulch Spreader is in operation.

Place the first layer of bales "lengthwise" on the truck. The second layer of bales should be placed "crosswise". Alternate successive layers lengthwise and crosswise in order to secure the load.

Leave enough room at the rear of the truck bed for the bale handler to stand.

## PRE-START CHECK:

Safety check to insure operator safety:

1. A. Skid Unit - Check condition of all mounting hardware securing the Mulch Spreader to the truck bed.  
B. Trailer Unit - Inspect hitch, safety chains, lights, and trailer mounting hardware. Check brakes and breakaway switch (if equipped).
2. Insure that all guards are in place.

## EQUIPMENT CHECK:



**CAUTION:** Equipment check is made with the engine off and all rotating parts stopped.

1. Tool kit - see that it contains following items: twine knife (#20057) and engine operator's manual.
2. Check beater box for foreign objects that could damage the equipment or injure workers.
3. Check fuel tank. Use gasoline only.
4. Check engine oil - refer to engine operator's manual.
5. Inspect air cleaner for dust and dirt - refer to engine operator's manual.
6. Check beater assemblies and their mounting pins for damage or wear. Replace if necessary.
7. Lubricate equipment - use hand gun only (see lube chart page 11).

## STARTING PROCEDURE:



**CAUTION:** See safety section of the manual (pages 2-4) before operating the machine.

1. Place the clutch switch in the "DISENGAGE" position.
2. Set throttle about ¼ open.
3. Pull Choke control out.
4. Turn the key clockwise until the starter engages, and the engine starts.
5. Push the Choke control in for even running.
6. Allow the engine to warm up for 3 to 5 minutes.

**NOTE:** This engine has a safety system that will shut the engine off if the oil pressure decreases below an acceptable level.

5. With the engine running between 1250-1750 rpm (check tachometer), move the clutch switch to the "ENGAGE" position. The clutch is then activated using an electrical pulse and will gradually engage over a 3 second time span.

**NOTE:** When starting your B-40 Mulch Spreader under cold conditions: until engine warms to the appropriate operating temperature it may be necessary to slightly increase the choke before engaging the blower.

## CREW MEMBERS AND THEIR DUTIES:

1. The Operator controls the placement of the mulch on the seedbed by moving the discharge assembly. He also controls the movement of the towing truck along the seedbed by using a predetermined set of hand signals.
2. The Bale Handler operates from the truck bed and supplies the feeder with bales of mulch material, cut side up.
3. The Bale Feeder cuts and disposes of the twine or wire; separates the bale in 1½" to 2" bats and feeds those into the beater box allowing about a 10" space between bats. Uniform feeding assures fast separation and more uniform application. DO NOT REACH INTO THE BEATER BOX, while the machine is running.
4. The Truck Driver follows the directions of the operator for the movement of the towing truck. The truck driver should be cautious in starting or stopping the truck so that the crew members are not thrown off balance.

## BLOWER DISCHARGE:

The B-40 Mulch Spreader should be towed to a point approximately 20 ft (6 m) from the area where the mulch is to be applied. The operator elevates the discharge spout about 10° above the plain of the seedbed so that the mulch floats onto the seedbed.

Do not drive the mulch into the seedbed with air pressure. The higher the tube is held, the more uniform the application will be.

A full circle horizontal travel of the discharge spout allows the operator to vary the direction of the discharge spout according to the prevailing winds. The tube should never be directed into the wind, towards any persons, or at the towing vehicle. Use the engine throttle to control the distance of the mulch.



**CAUTION:** Be sure beater assemblies are mounted opposite each other at all times to avoid throwing the blower shaft out of balance.

If any obstruction stops the flow of mulch, immediately disengage clutch and shut off engine. Do not reach into the beater box or attempt any adjustment until the engine and all rotating parts have stopped. When the obstruction has been removed, the motor can be restarted and mulch application can continue.



**DANGER:** Do not reach into the beater box or attempt any adjustment until the engine and all rotating parts have stopped.

## **CLEANING AND MAINTENANCE:**

### **AFTER FIRST 4 - 8 HOURS OPERATION:**

1. Check and adjust belt. Proper belt tension is obtained when 3/8" (1 cm) of belt deflection is obtained at the center of the belt span with a force of 5 (used belt) to 7 (new belt) pounds (2.2 to 3.2 kg).
2. Retorque wheel lugs (85-98 ft.lbs. (12-13 kg-m)) - again after 7 days. (Trailer option only).

### **DAILY CLEAN-UP MAINTENANCE:**

Follow this procedure daily to keep the equipment in good operating condition:

1. Clean the air cleaner following the instructions in the engine operator's manual.
2. Check air cleaner connections. If they come loose or disconnected, warranty on your engine is subject to cancellation.
3. Clean the beater assemblies, making sure to remove all twine, wire, and other foreign objects. Check pins and nuts.
4. Lock the discharge tube into place.
5. Check engine oil level.
6. Check hitch and safety chains.

### **WEEKLY MAINTENANCE:**

After each 50 hours of operation, follow this procedure:

1. Change engine oil, following engine manufacturer's recommendations after the first 50 hours and then every 100 hours.
2. Change the engine oil filter cartridge with every oil change (once every 100 hours).
3. Lubricate bearings with general-purpose chassis lubricant, using a grease gun. Wipe each bearing before lubrication to remove dirt and prevent overheating.
4. Inflate tires to 35 psi (241 kPa).
5. Check belt adjustment.



**CAUTION:** Adjust only while engine is off and all rotating parts stopped.

## LUBRICATION AND FLUIDS CHART

Ref. No.	Location	Lubricant	Frequency	Number
1.	Grease drive shaft bearings	CL	Weekly	2
2.	Check fuel tank level	GA	Daily	1
3.	Check engine oil level	MO	Daily	1
4.	Check air cleaner		Daily	1
	Service precleaner element		Every 25 Hours	1
	Change air cleaner element		Every 100 Hours	1
5.	Change engine oil & filter	MO	Every 100 Hours	1

### LUBRICANT OF FLUID USED

CL	Chassis Lubricant
MO	Motor oil SAE 30 CD/SF
GA	Gasoline Fuel

### TIME KEY

DAILY



WEEKLY



Every 100 Hours



### FLUID CAPACITIES

Fuel - 5.5 gallons

Engine Oil - 2.1 Quarts

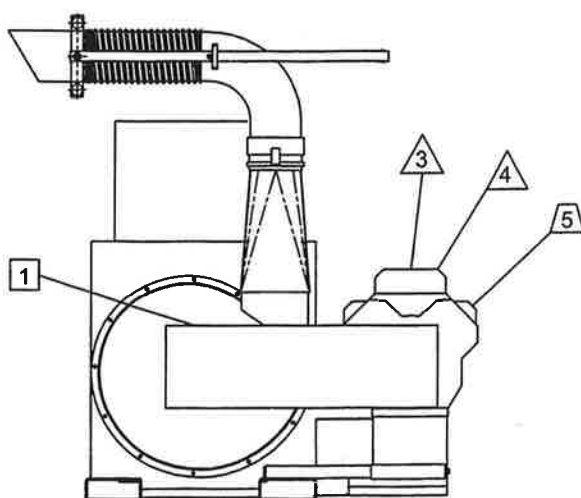
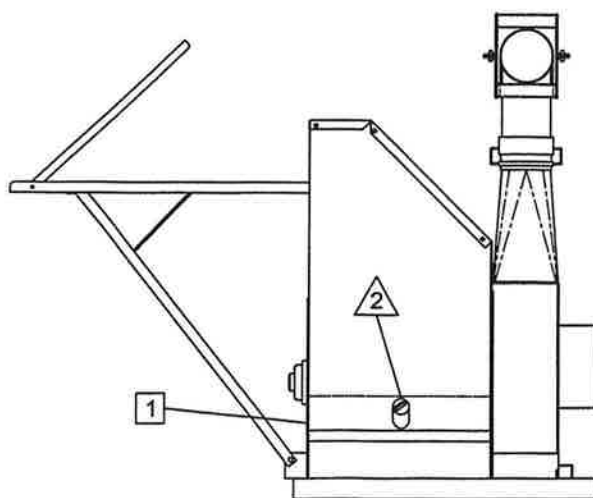





# **B-40**

## **Mulch Spreader Parts Manual**

Model No. SSA

Serial No. \_\_\_\_\_



# INDEX

---

Blower Shaft Assembly .....	16
Discharge Assembly .....	17
Beater Box and Feed Chute .....	18-19
Control Box Assembly.....	20
Decal Location .....	21

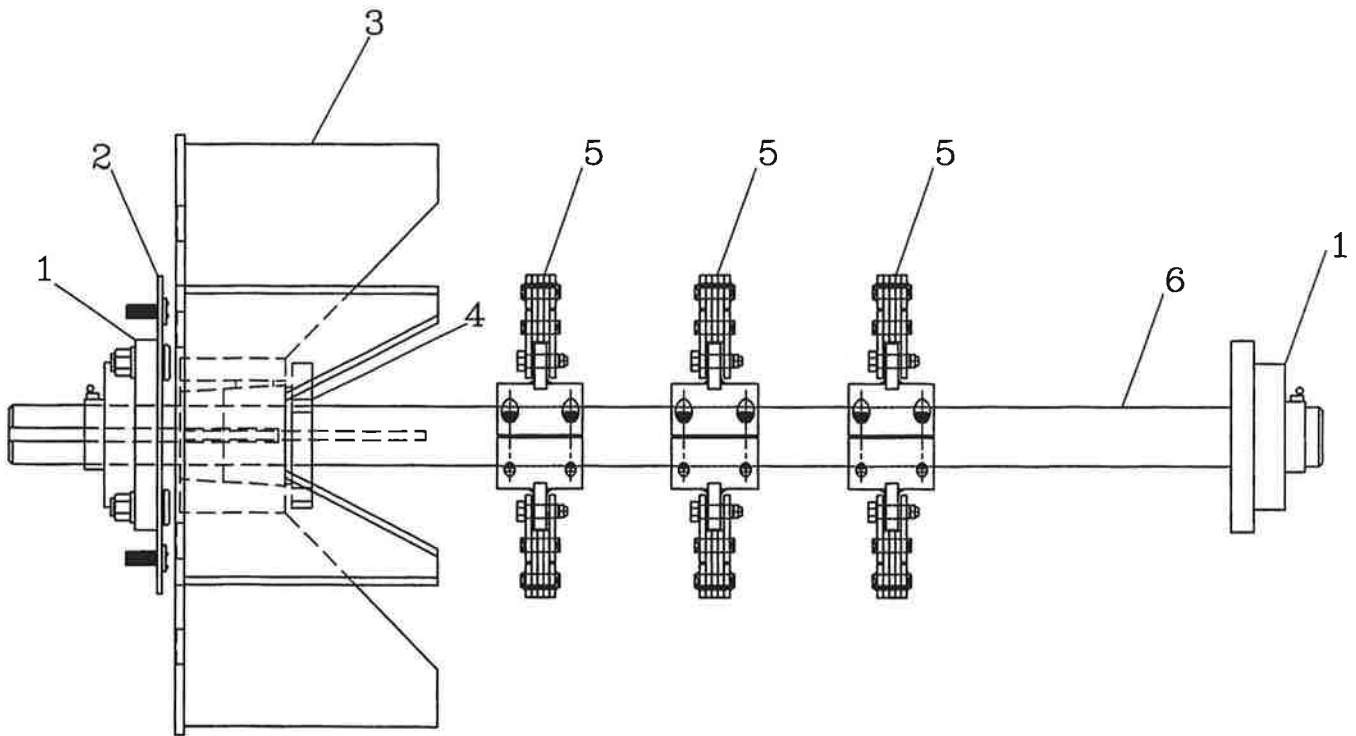

### BLOWER SHAFT ASSEMBLY

Ref. No.	Part No.	Description	No. Req'd.
1	035033	Blower Shaft Bearing	2
2	035021	Shaft Pad	1
3	035104	Blower Blade Weldment	1
4	003051b	Blower Bushing w /Key	1
	190125-70	Blower Blade Key	1
5	035081	Beater Chain Assembly	3
	022487	5/16 Flex Lock Pivot Nut	6
	020119	Hardened Shoulder Bolt	6
	035080	Breaker Hub Weldment	3
	020238	2 Pitch Beater Chain	6
6	035013	Blower Shaft	1
	035074	Driven Sheave	1

**WHEN ORDERING PARTS, BE SURE TO STATE  
SERIAL NUMBER OF MACHINE**

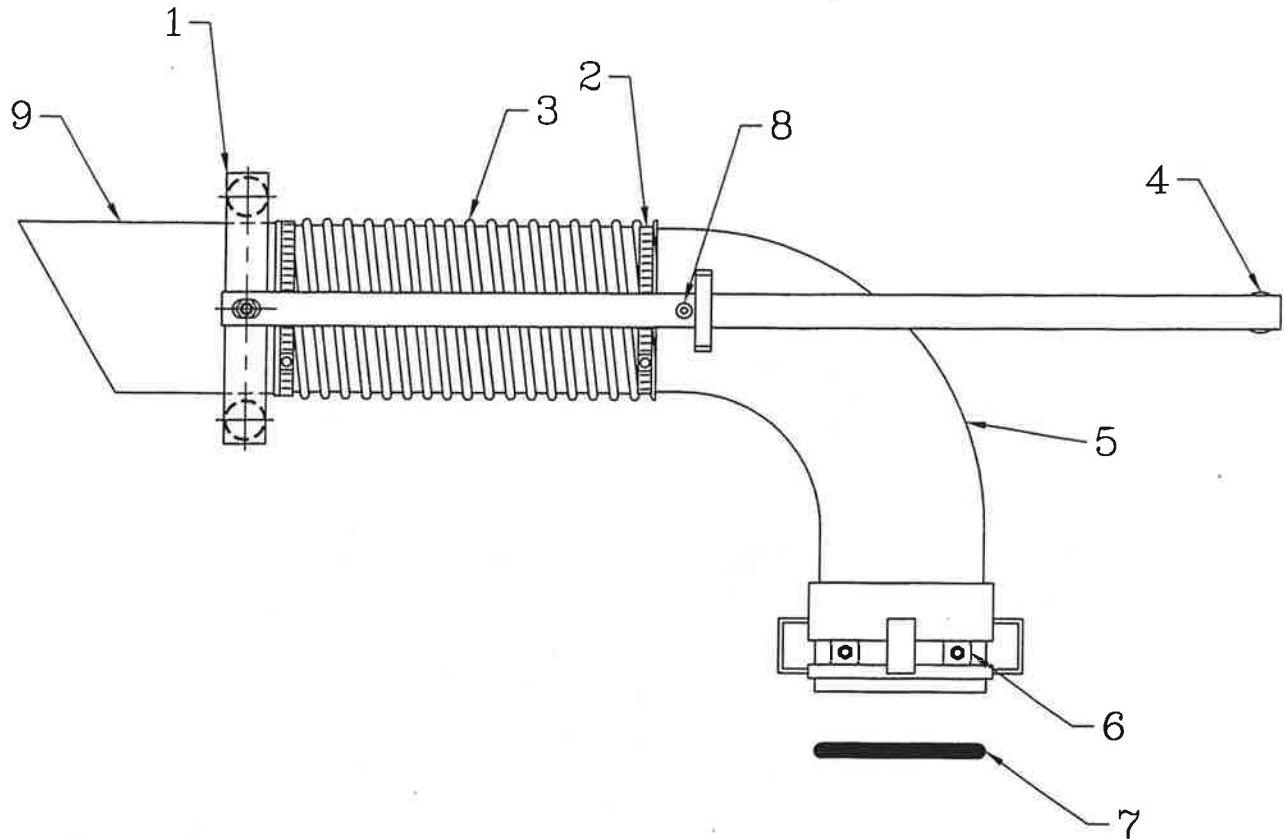

### DISCHARGE ELBOW ASSEMBLY

Ref. No.	Part No.	Description	No. Req'd.
1	035096	Discharge Hose Bridle	1
2	035036	Clamp	2
3	035110	Discharge Hose	1
4	035043	Discharge Handle	1
5	035019-01	6" Discharge Elbow	1
6	035024-09	Elbow Bearing	4
7	035037	O-Ring	1
8	035086	Stainless Steel Shoulder Bolts	4
9	035024-10	Discharge Tube	1

**WHEN ORDERING PARTS, BE SURE TO STATE  
SERIAL NUMBER OF MACHINE**

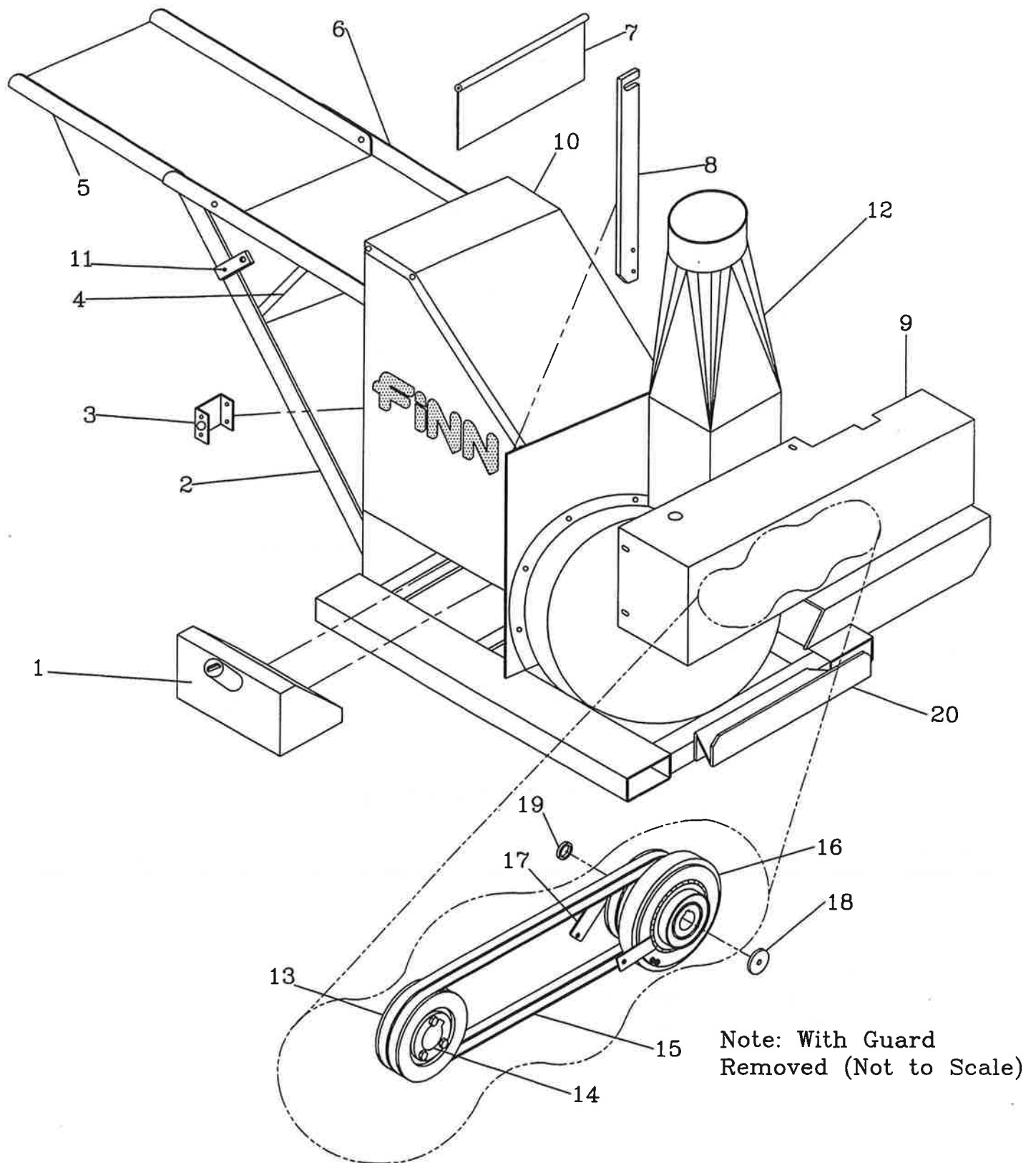

**WHEN ORDERING PARTS, BE SURE TO STATE  
SERIAL NUMBER OF MACHINE**

**BEATER BOX AND FEED CHUTE**

<b>Ref. No.</b>	<b>Part No.</b>	<b>Description</b>	<b>No. Req'd.</b>
1	035022	Gasoline Fuel Tank	1
	035012-02	Fuel Tank Holder	1
	007914	Gas Cap	1
2	035004-01	Feed Chute Support	1
3	035109-02	Shaft Guard Cover	1
	035109-01	Shaft Cover Guard Base	1
4	035004-02	Chute Gusset	1
5	035003-01	Feed Chute Extension	1
6	035003-02	Feed Chute	1
7	035018	Feed Swing Door	1
	035018-04	Swing Rod	1
8	035012-01	Tube Hold Down	1
	031245	Snapper Pin	1
9	035070	Belt Guard	1
	035071	Belt Guard Support	1
10	034008	Beater Box Cover	1
11	035018-07	Feed Chute Latch	1
	035041	Cotterless Hitch Pin	1
12	035042	Transition Weldment	1
13	035074	Clutch Sheave	1
14	030876	Clutch Bushing	1
15	035075	Gripnotch Belts – Matched set of 2	1
16	035073	Electric Clutch	1
17	035069-03	Clutch Retaining Strap	1
	X0464	Retainer Bolt	1
	Y04L	Retainer Nut	1
	035025	20 HP Engine	1
18	035069-05	Clutch Retaining Washer	1
19	035069-04	Notch Spacer	1
20	035083	Bumper Guard	1
	KL2406817	Muffler	
	KL1205001	Oil Filter	
	KL2488303-S1	Air Filter	
	KL2505002	In-Line Fuel Filter	

**WHEN ORDERING PARTS, BE SURE TO STATE  
SERIAL NUMBER OF MACHINE**

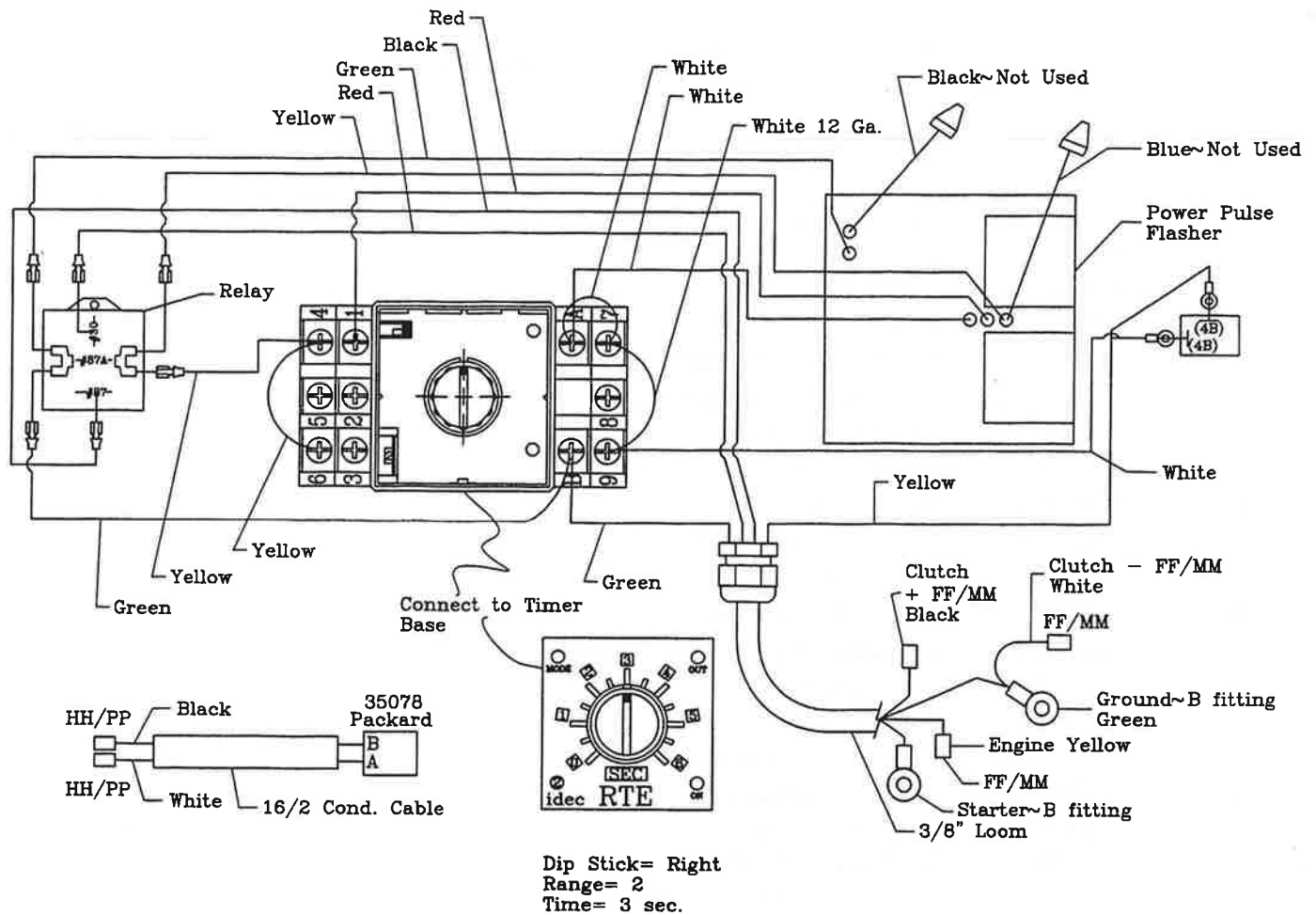

## CONTROL BOX WIRING

Ref. No.	Part Number	Description	No. Req'd
	035102	Control Box Wiring	1
1	035098	Power Pulse Flasher	1
2	052112	Toggle Switch	1
3	080526	Toggle Switch Boot	1
4	055122	Idec Timer	1
5	055125	Idec Timer Base	1
6	FW71749-02	Relay	1
	010516	Ground Strap	1
	080524	Battery	1
	035073	Electric Clutch	1
	035103	Enclosure Box	1
	031031	2 GA. Red Battery Cable	1

**WHEN ORDERING PARTS, BE SURE TO STATE  
SERIAL NUMBER OF MACHINE**



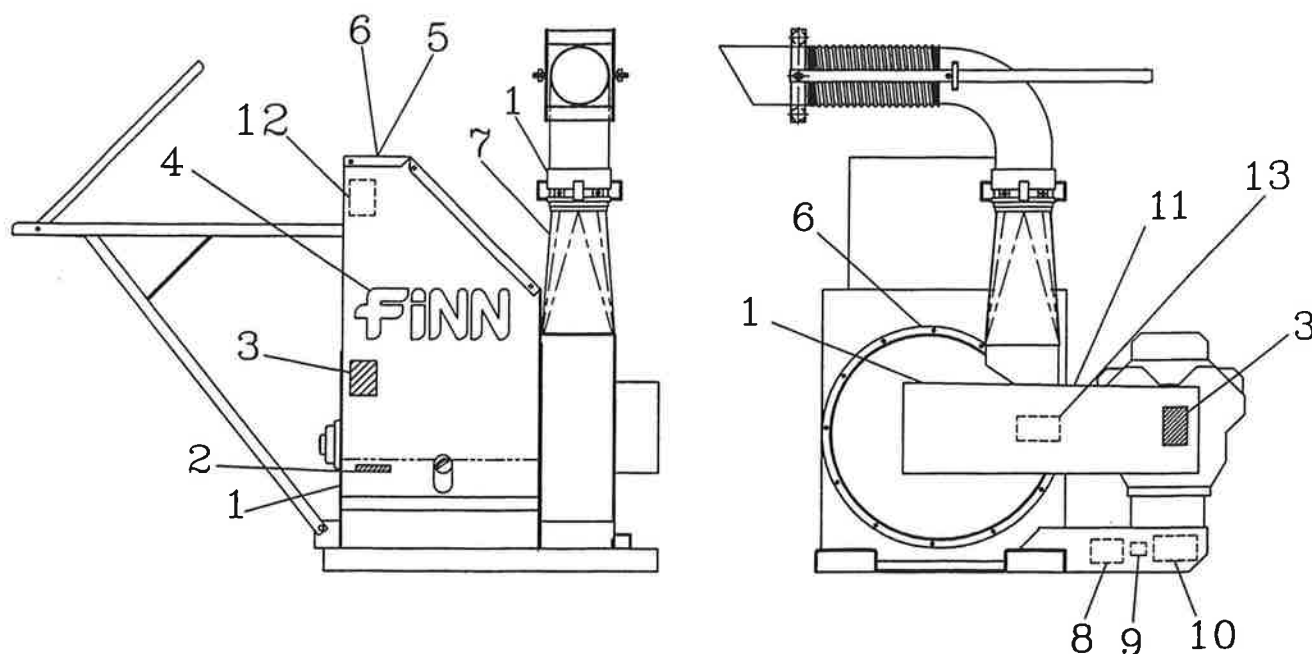

### B40 DECALS

Ref. No.	Part No.	Description	No. Req'd.
1	007231	"Service Weekly"	3
2	031331	"Gasoline"	1
3	012179	"WARNING! Do Not Operate With Out Guards"	2
4	031235	"FINN"	2
5	023519	"CAUTION! Wear Eye Protection"	1
6	020068	"DANGER! Rotating Parts"	2
7	055280	"WARNING! Thrown Object"	1
8	012260	"Maintain Safety Decal Plate"	1
9	020976	"Patent Infringement"	1
10	011690	"FINN Name Plate"	1
11	012278	"DANGER! Hot Exhaust"	1
12	035106	"Operating Instructions"	1
13	035101	"CAUTION! Area Around Engine Must..."	1
	035052	"Clutch Engage / Disengage"	1

Note: Safety Decals must be purchased as a kit

Part # 035133

**WHEN ORDERING PARTS, BE SURE TO STATE  
SERIAL NUMBER OF MACHINE**



## EQUIPMENT REGISTRATION

### (SECOND OWNER)

To enable FINN CORPORATION to maintain a record of equipment owners for parts assistance, FINN information and other purposes, we request the completion and return of this form. THANK YOU FOR YOUR COOPERATION.

EQUIPMENT \_\_\_\_\_ MODEL \_\_\_\_\_ SERIAL # \_\_\_\_\_

DATE OF PURCHASE \_\_\_\_\_ PURCHASED FROM \_\_\_\_\_

NEW OWNER \_\_\_\_\_

PHONE (      ) \_\_\_\_\_ FAX (      ) \_\_\_\_\_ E-MAIL \_\_\_\_\_

STREET ADDRESS \_\_\_\_\_ MAIL ADDRESS \_\_\_\_\_

CITY \_\_\_\_\_ STATE \_\_\_\_\_ ZIP \_\_\_\_\_

DO YOU OWN OTHER FINN EQUIPMENT? ☐ YES ☐ NO

MODEL AND SERIAL NUMBER(S) \_\_\_\_\_

DO YOU OWN OTHER COMPETITIVE EQUIPMENT? ☐ YES ☐ NO BRAND \_\_\_\_\_

WHAT IS YOUR PRIMARY BUSINESS? \_\_\_\_\_

**WHEN COMPLETED, PLEASE RETURN PROMPTLY. POSTAGE NOT REQUIRED.**

## EQUIPMENT REGISTRATION

### (FIRST OWNER)

To enable FINN CORPORATION to maintain a record of equipment owners for parts assistance, FINN information and other purposes, we request the completion and return of this form. THANK YOU FOR YOUR COOPERATION.

EQUIPMENT \_\_\_\_\_ MODEL \_\_\_\_\_ SERIAL # \_\_\_\_\_

DATE OF PURCHASE \_\_\_\_\_ PURCHASED FROM \_\_\_\_\_

NEW OWNER \_\_\_\_\_

PHONE (      ) \_\_\_\_\_ FAX (      ) \_\_\_\_\_ E-MAIL \_\_\_\_\_

STREET ADDRESS \_\_\_\_\_ MAIL ADDRESS \_\_\_\_\_

CITY \_\_\_\_\_ STATE \_\_\_\_\_ ZIP \_\_\_\_\_

DO YOU OWN OTHER FINN EQUIPMENT? ☐ YES ☐ NO

MODEL AND SERIAL NUMBER(S) \_\_\_\_\_

DO YOU OWN OTHER COMPETITIVE EQUIPMENT? ☐ YES ☐ NO BRAND \_\_\_\_\_

WHAT IS YOUR PRIMARY BUSINESS? \_\_\_\_\_

**PLEASE COMPLETE THE FIRST OWNER REGISTRATION AND RETURN PROMPTLY. POSTAGE NOT REQUIRED.  
SECOND OWNER COPY TO REMAIN IN PARTS MANUAL.**



NO POSTAGE  
NECESSARY  
IF MAILED  
IN THE  
UNITED STATES



**BUSINESS REPLY MAIL**

FIRST-CLASS MAIL PERMIT NO. 6359 FAIRFIELD, OHIO

POSTAGE WILL BE PAID BY ADDRESSEE

**FINN CORP**  
**9281 LESAINTE DR**  
**FAIRFIELD OH 45014-9940**

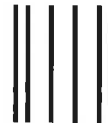

NO POSTAGE  
NECESSARY  
IF MAILED  
IN THE  
UNITED STATES



**BUSINESS REPLY MAIL**

FIRST-CLASS MAIL PERMIT NO. 6359 FAIRFIELD, OHIO

POSTAGE WILL BE PAID BY ADDRESSEE

**FINN CORP**  
**9281 LESAINTE DR**  
**FAIRFIELD OH 45014-9940**

